



5922 W Bowcroft Street

Los Angeles, CA 90016

± 25,461 SF Industrial Building for Lease

Ron Rader, SIOR
310.245.2200
rrader@leewestla.com

Gage Danley
310.899.2749
gdanley@leewestla.com

Premises

± 25,461 SF
Can be fully air conditioned

Rent

\$2.65, SF/Net
Opex: \$0.49/SF/Mo

Occupancy

Immediate

Term

5+ Years

Parking

50 Car Parking

Features

- Full Renovation Underway
- Refurbished Offices ± 1,500 SF - 6,000 SF
- Upgraded Bathrooms and Break Room
- All New Lighting
- Two (2) Ground Level Loading Doors
- Bow Truss Ceiling
- 14 - 25 Foot Clear Height
- Five (5) Offices and One (1) Conference Room
- Ample Power
- One (1) Shared Dock High Loading Position
- Stable Ownership (Owned Free and Clear) since 1920
- Parking for approximately 50 cars
- Culver City Adjacent

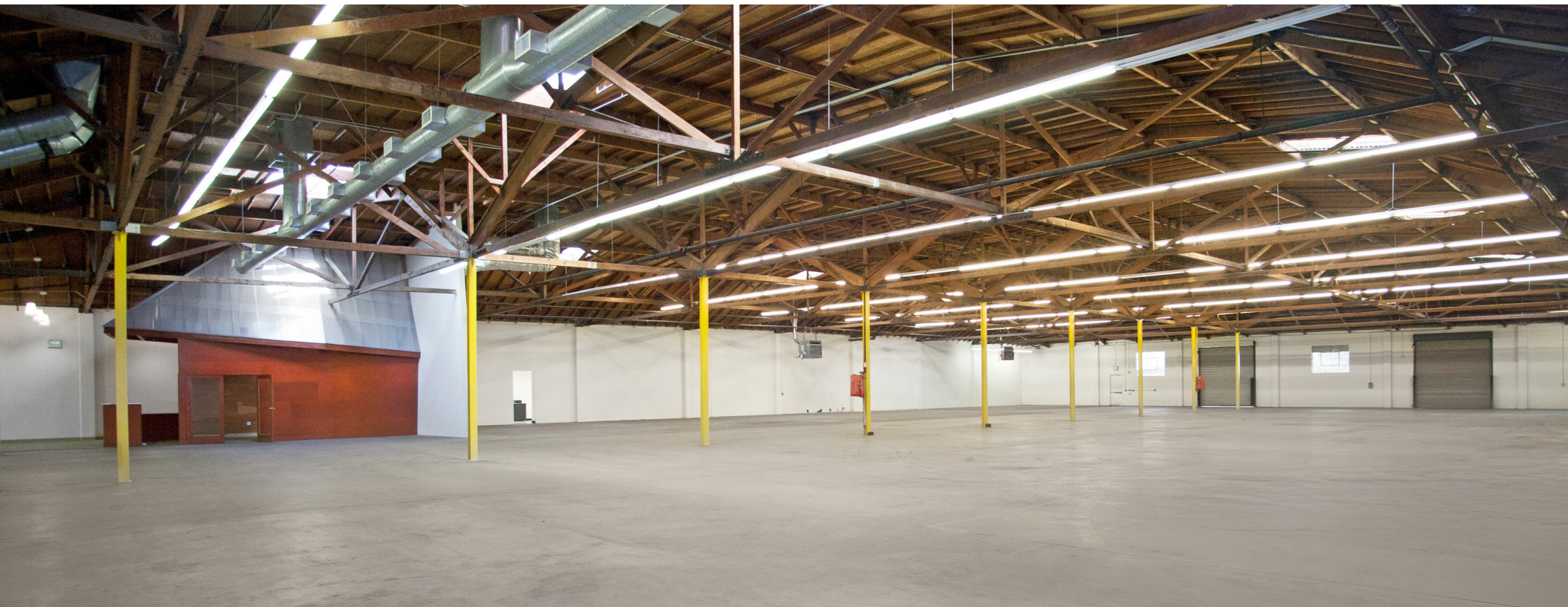

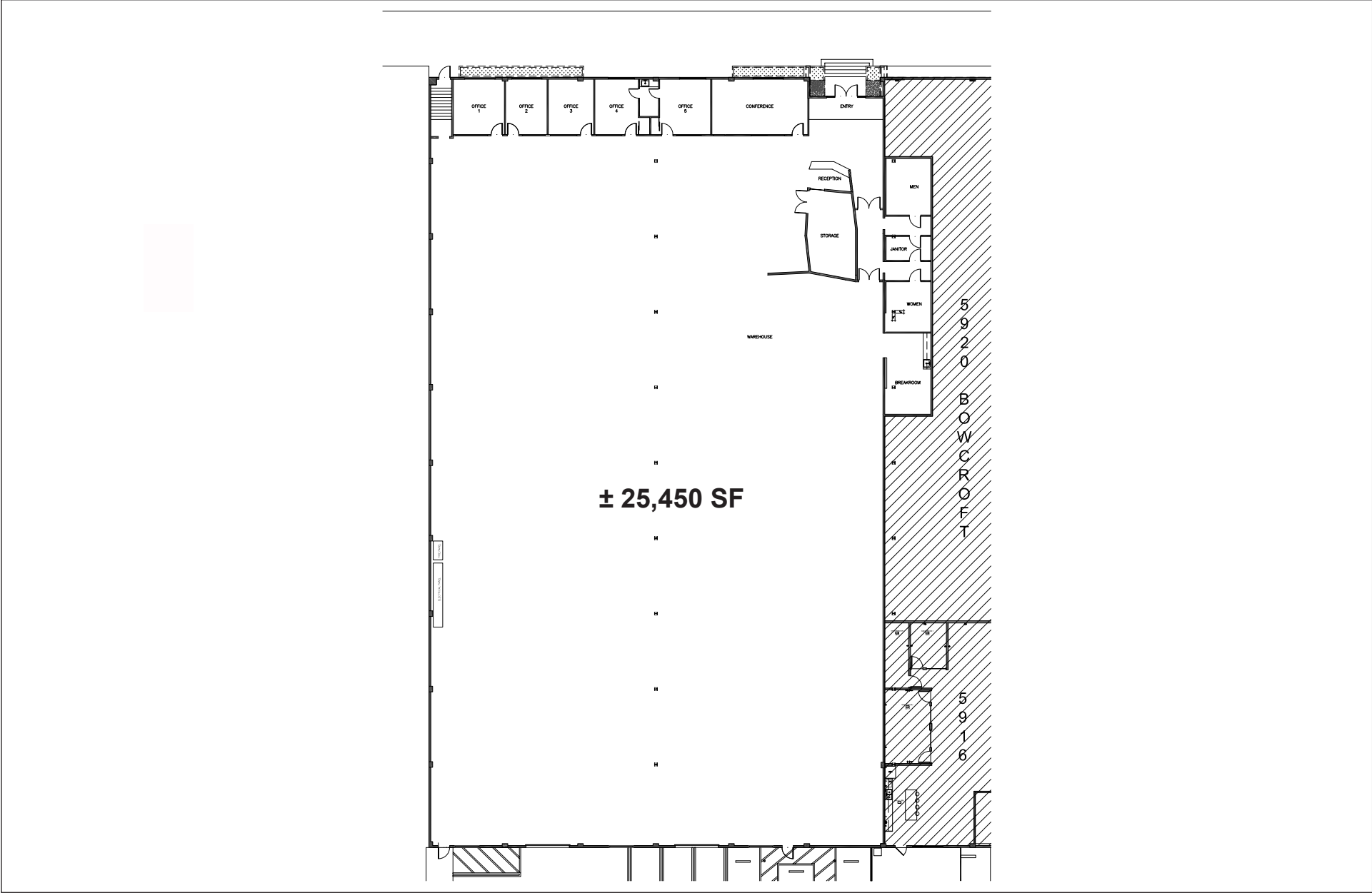



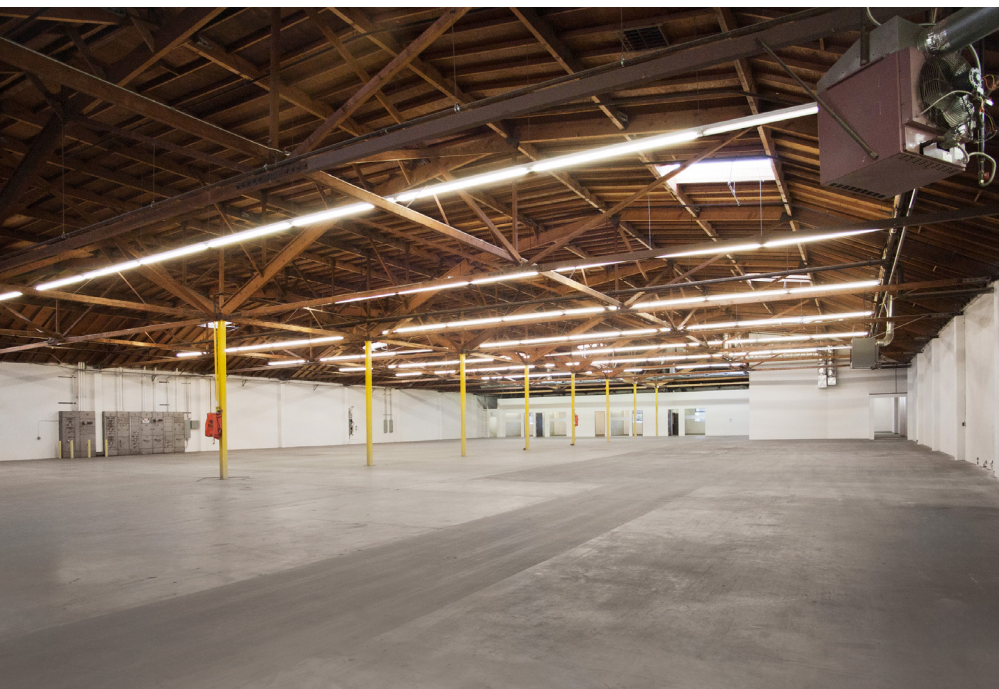



5922 Bowcroft St

Nearby Restaurants & Amenities

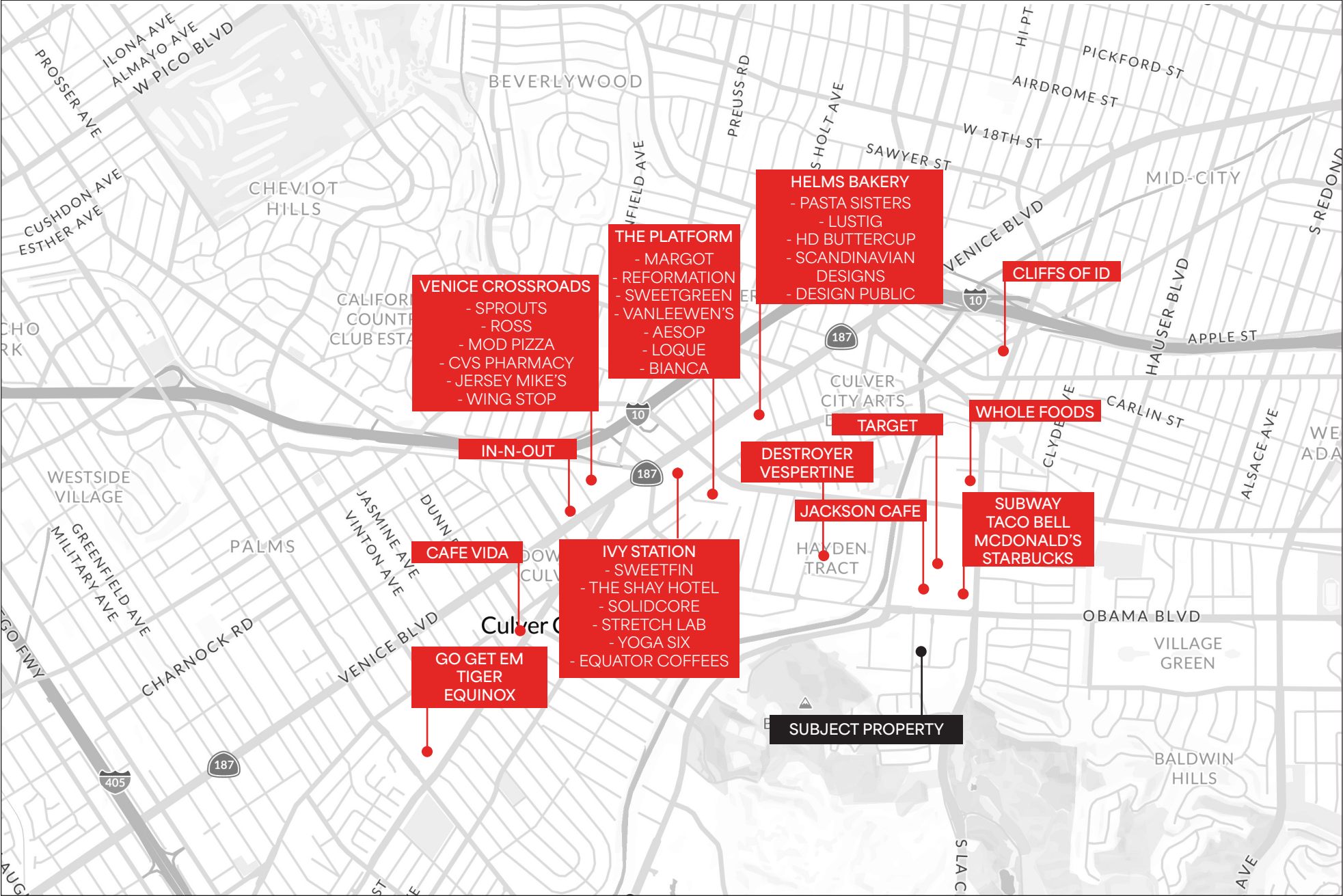

5922 Bowcroft St

Nearby Tenants

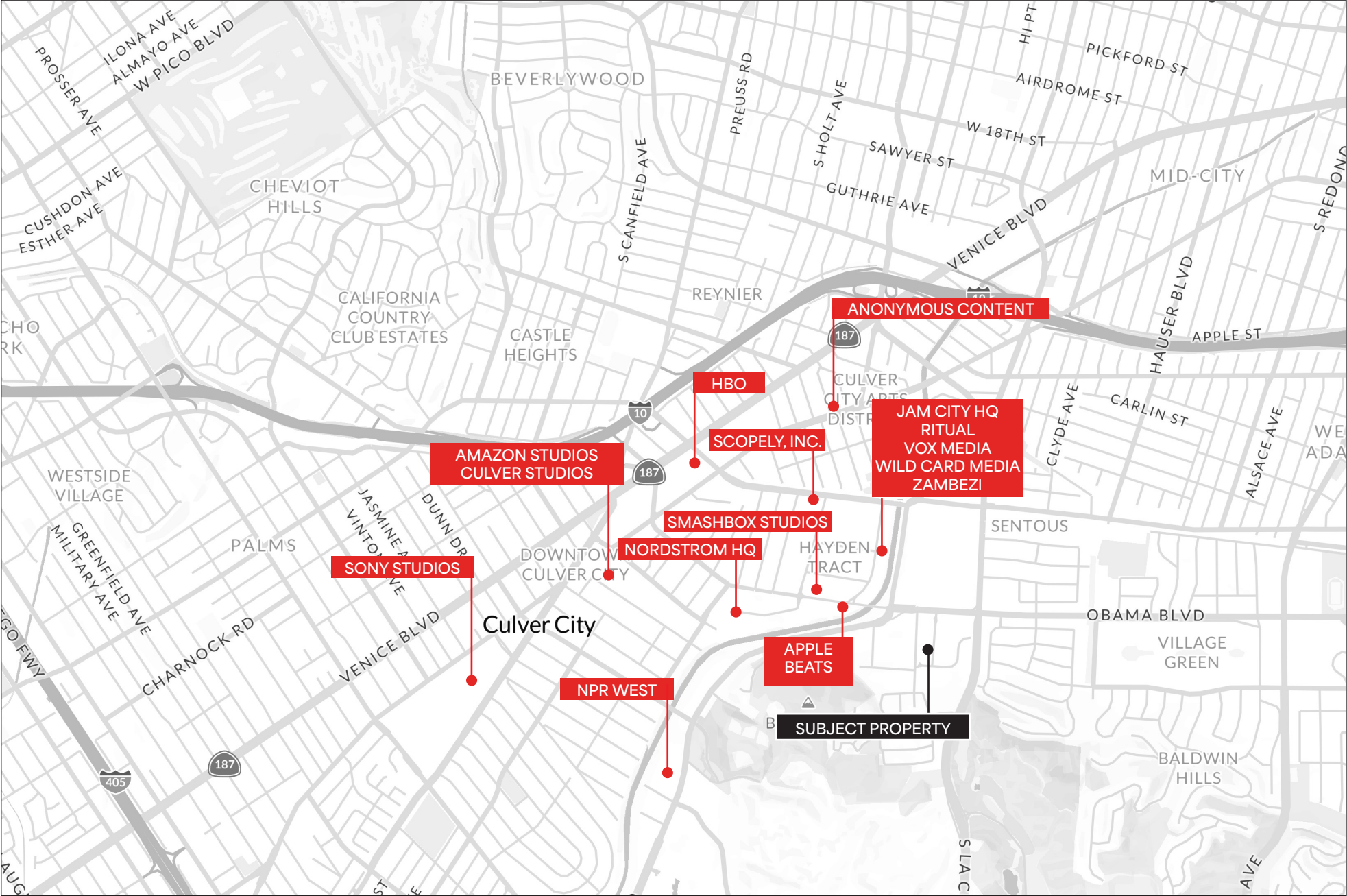

5922 W Bowcroft Street

Los Angeles, CA

Ron Rader, SIOR

310.245.2200

rrader@leewestla.com

BKR DRE 00452728

Gage Danley

310.899.2749

gdanley@leewestla.com

AGT DRE 02075191



A DIVISION OF



No warranty or representation is made to the accuracy of the foregoing information.
Terms of sale or lease are subject to change or withdrawal without notice.