

# RÓMA

romacondominium.com

## 25-23 NEWTOWN AVENUE

### UNIT 3F-5F

1 Bedroom  
1 Bathroom  
INT: 779 SQ FT  
EXT: 129 SQ FT

### RESIDENCE FEATURES

- Custom European Kitchen & Vanity
- Grohe Fixtures
- Italian Porcelain Tile
- Appliances by Bosch
- Washer / Dryer
- Quartz Counters and Backsplash
- Vented Kitchens
- Double-Pane Custom Windows
- European White Oak Floors

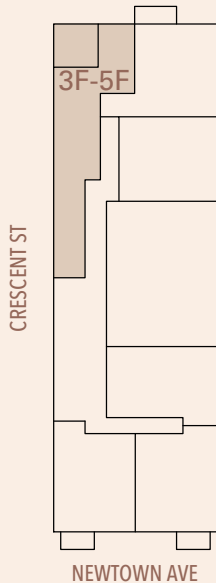

Aleksey Gavrilo  
agavrilo@corcoran.com  
(347) 617-7690

Joseph Grosso  
jgrosso@corcoran.com  
(917) 328-7824

**GAVRILOV  
GROSSO  
TEAM**  
AT THE CORCORAN GROUP

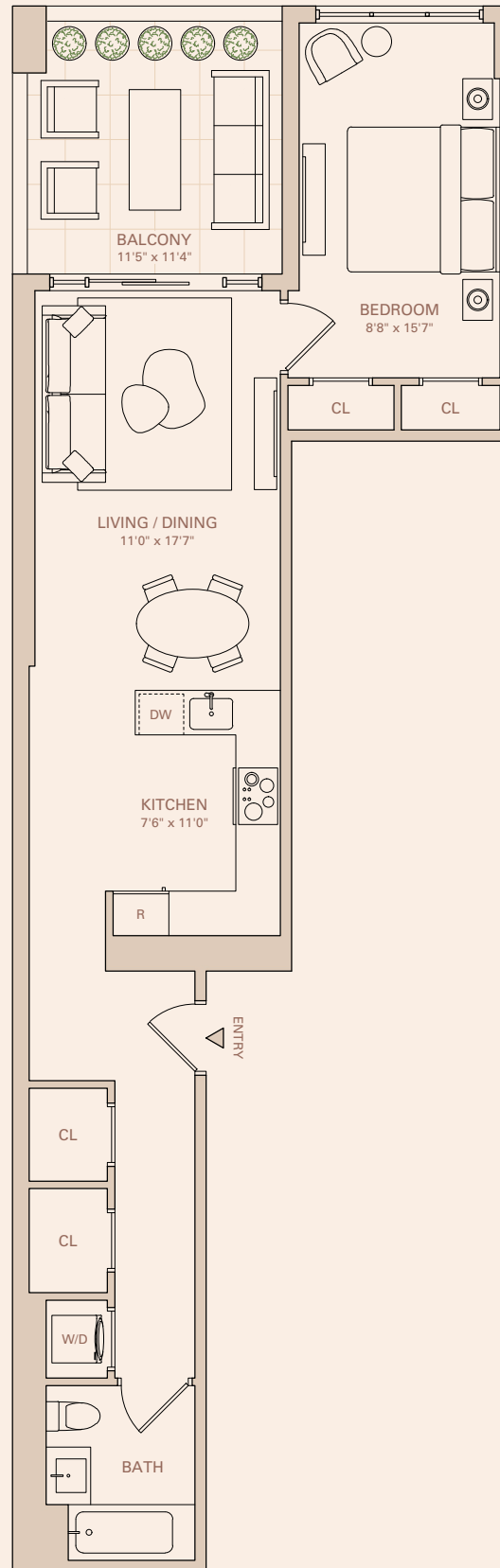

Exclusive Sales & Marketing by The Gavrilo Grosso Team at The Corcoran Group

The complete offering terms are in an offering plan available from Sponsor. File No. CD25-0053. All dimensions are approximate and subject to the construction variances and tolerances. Plans and dimensions may contain minor variations from floor to floor. Sponsor reserves the right to make changes in accordance with the offering plan. Equal Housing Opportunity.